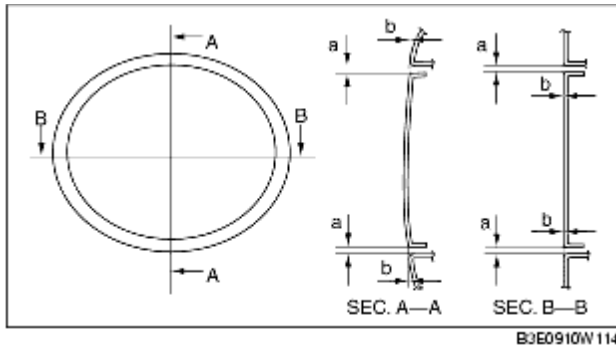

FUEL-FILLER LID ADJUSTMENT

B3E091042410W02

1. Measure the gap and height difference between the fuel-filler lid and the body.
2. Loosen the fuel-filler lid installation bolts, and adjust the fuel-filler lid.

**Standard clearance****a: 1.7-3.7 mm {0.067-0.14 in}****b: -0.5-1.5 mm {-0.019-0.059 in}**

3. Tighten the bolts.